



INSTRUCTION MANUAL

PORTABLE AC



READ ENTIRE MANUAL BEFORE USE

Congratulations!

Thank you for choosing Chillwell™! Customer satisfaction is our #1 priority!

If you have any questions or problems, please email:

ChilWell@rephelpdesk.com

If you can't find the answer or do not have access to the internet,
call our customer service line Monday-Friday 9am to 6pm EST:

1-888-998-6324

WHAT'S INCLUDED

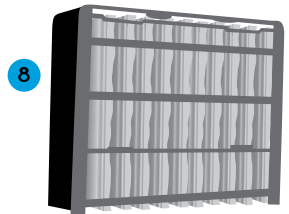
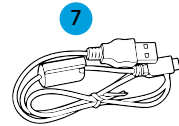
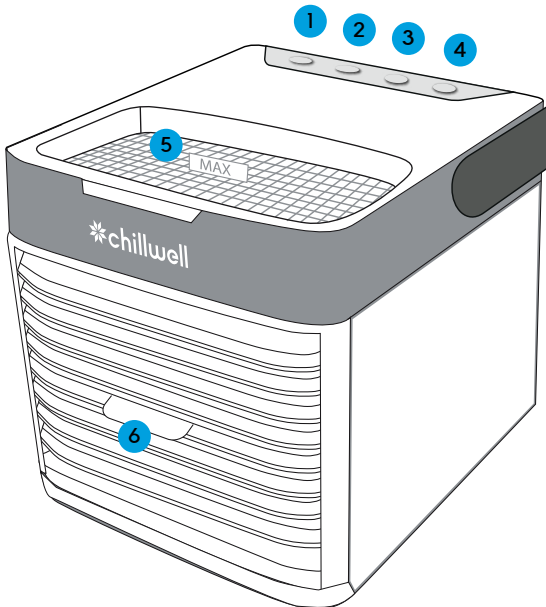

1. Power/Fan Speed Button
2. Turbo Button
3. Cooling Control
4. Light On/Off Button

5. Water Tank Door
6. Air Direction Tab
7. USB Power Cord
8. Cooling Cartridge

CHARGING



1. Set Chillwell™ on a flat surface such as a table or desk. Plug the small end of the USB cable into the port located on the back of the unit.
2. Plug large end of USB cable into a USB-Power adapter, laptop, or other device (not included)
3. Charging Light will begin blinking to indicate unit is charging. When light remains solid, Chillwell™ is fully charged.

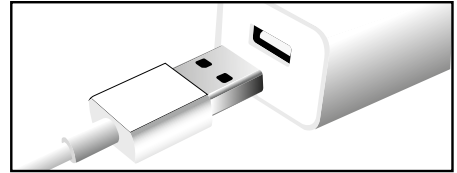
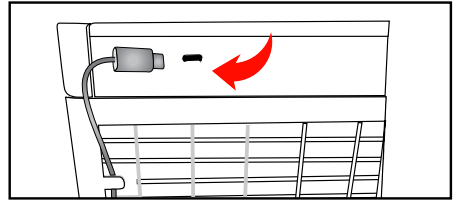

SETUP



1. Use the Cartridge Drawer Tab to pull out the cartridge drawer and remove cartridge.
2. For best results, lightly pre-soak under cold, running water. For even more cooling power, place a wet cartridge in the freezer until frozen. Place back in drawer when done.

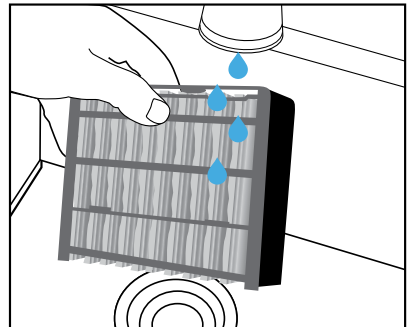
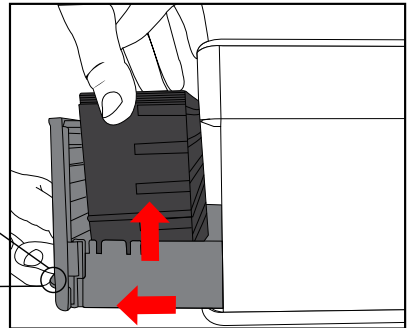
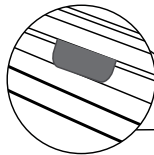

SETUP (CONT.)



3. Fill the water tank by gently pouring water into the opening until level reaches near the top. You can check by looking at the side of the tank.

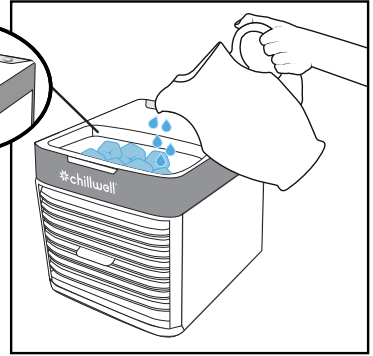
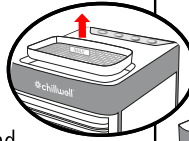

FOR BEST RESULTS: Remove the water tank lid and place ice cubes in tank prior to filling with water, and put lid back on. This will provide an extra cold blast of air. Repeat as ice cubes melt.

USAGE



1. Press the  button to turn Chillwell™ on - it will default to High speed mode.
 - 1st press: Power on, High
 - 2nd press: Medium
 - 3rd press: Low
 - 4th press: Power off

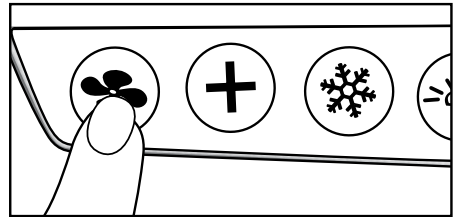

NOTE: Chillwell™ will run up to 8 hours on High, 10 hours on Medium and 12 hours on Low.

2. Press  to start TURBO mode for maximum fan power and cooling.
3. Use the Air Direction Tab to adjust airflow up/down to your preference.

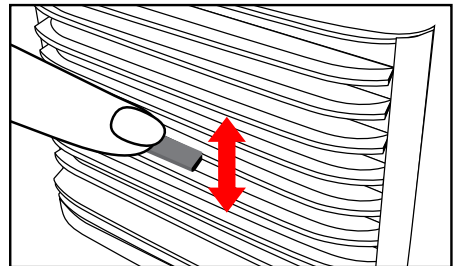
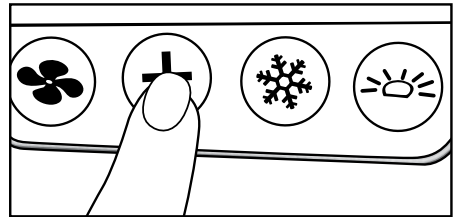

USAGE (CONT.)



4. Choose your light color by pressing ☀️ button.
You can choose between solid colors or a color-cycle mode. Color order: Blue, Red, White, Teal, Purple, Yellow, Green, Color Cycle
5. Control cooling output by pressing ❄️ button.
You can choose HIGH cooling mode or LOW cooling mode.

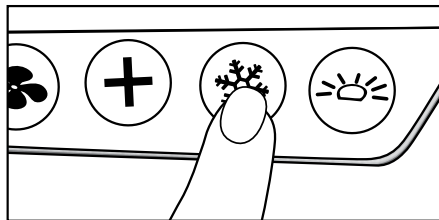
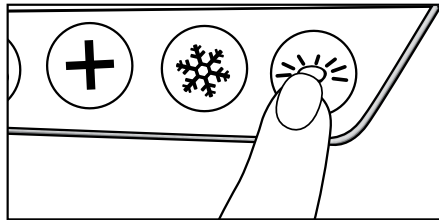

IMPORTANT: If you do not plan to use Chillwell™ for an extended period of time, it is recommended that you empty and let unit & cartridge dry before storing. This will avoid mold and unpleasant smells, and prolong life of ChillWell™ & the cartridge.

MAINTENANCE



We recommend weekly cleaning of your Chillwell™ and Cartridge to keep in best working condition, and replacing the Cartridge every 3-6 months.

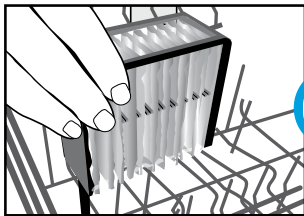

OR

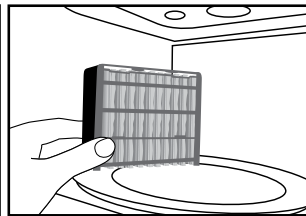
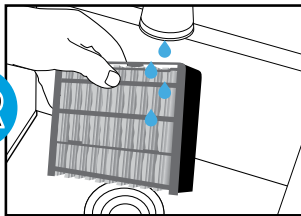

DISHWASHER: Place cartridge in the top-rack of your dishwasher & run cycle normally. Remove and let air dry.

HAND WASH: Hand wash gently with warm water & soap. Shake out excess water & let air dry.

MICROWAVE: Between washes, sanitize your cartridge by placing in microwave on high for 30 second increments, up to 2 minutes. Let sit until cool.

IMPORTANT: If you see mold on the cartridge or notice a musty smell, stop and clean the cartridge before further use. Fully submerge the cartridge in a pot or bowl filled with equal parts clean water and white vinegar – allow to soak for 45-60 minutes. Rinse with warm water, wring out and let air dry.

MAINTENANCE



UNIT CLEANING

- To prepare for cleaning, run Chillwell™ until all water has emptied from the water tank, or hold Chillwell™ over a sink and carefully dump out to avoid splashing or spilling.
- Remove cartridge tray from Chillwell™. Using warm, soapy water, wipe cartridge tray and grill, then rinse off until clean. Let air dry.
- If you notice water tank is dirty, use a small, bendable brush (i.e. toothbrush, bottle brush, etc) and carefully clean the inside of the tank until clean. Rinse clean with warm water.

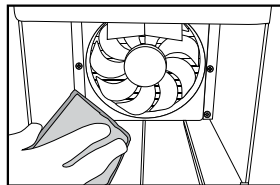
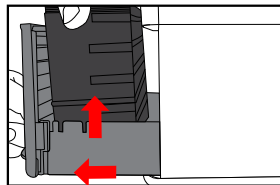

**TO ORDER A
NEW CARTRIDGE**

 Web: www.ChillWellCartridge.com

 Call: 1-888-998-6324

 Email: ChillWell@rephelpdesk.com

WARNINGS



- Do not carry Chillwell™ when filled with water. Some water may remain in unit even if tank is empty.
- Use only clean water. If needed, use distilled water.
- Please read and follow regular maintenance as recommended in “Maintenance” section of this guide.
- Chillwell™ works best in non-polluted areas. Large dust/dirt particles may reduce lifetime of unit.
- We recommend use only in dry locations. If using in a moist area or environment, take care not to get water on external areas of the product.
- If a leak or spill occurs on the surface of device, unplug Chillwell™ and let it dry for 24 hours. Then, use as normal.
- Do not place in direct sunlight for extended periods of time.

WARNINGS



- Before not using Chillwell™ for extended periods of time, empty the water tank, turn unit on, and set to highest fan speed for at least 4 hours. This will dry out then cartridge and inside of your unit.
- Only use the original power adapter and cord supplied in package.
- Do not touch the power supply or power cord with wet hands.
- Unplug Chillwell™ when cleaning, removing/replacing cartridge, or moving the device.
- For best results, place Chillwell™ on a higher surface like a table or countertop.
- Do not place Chillwell™ near a heater or any electrical equipment.
- Do not place the device in passageways or high traffic areas where there is a possibility of tripping or knocking it over.
- Do not allow any foreign objects inside Chillwell™.
- Do not place items on top Chillwell™.
- Do not block the front and back grills of the device.
- Do not turn the device upside down.
- Do not submerge the Chillwell™ under water or other liquids.
- Do not place Chillwell™ near open flames or fire sources.
- People with limited physical, visual or mental abilities or lacking proper experience and/or knowledge should never use the device without supervision of those responsible for their safety or those capable of assistance in using the device.
- The device can be switched off completely only when disconnected from the power supply.
- The manufacturer does not bear any responsibility for any damage from failure to comply with this product guide.
- A replaceable water cartridge is designed specifically for this product. If your cartridge has been broken or damaged, you can purchase a replacement.

CHILLWELL™ ASSUMES NO RESPONSIBILITY FOR ANY INCIDENTAL OR CONSEQUENTIAL DAMAGES ARISING OUT OF YOUR USE OF THE PRODUCT. IN PURCHASING AND USING THIS PRODUCT, YOU ASSUME ALL RESPONSIBILITY FOR CLEANING THE PRODUCT AND MONITORING THE PRODUCT FOR MOLD. ADDITIONALLY, CHILLWELL™ SPECIFICALLY DISCLAIMS ALL EXPRESSED WARRANTIES NOT OTHERWISE SET FORTH HEREIN AND ANY IMPLIED WARRANTIES OF MERCHANTABILITY OR FITNESS FOR A PARTICULAR PURPOSE. THERE ARE NO WARRANTIES WHICH EXTEND BEYOND THE DESCRIPTION OF THE FACE HEREOF.

FOR BEST RESULTS



PRE-SOAK CARTRIDGE:

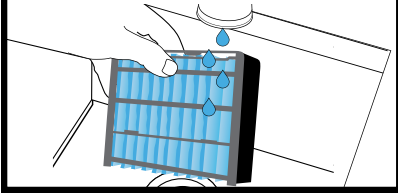

To **ACTIVATE COOLING**, soak your cartridge under running cold water.

PLACE IN FREEZER:

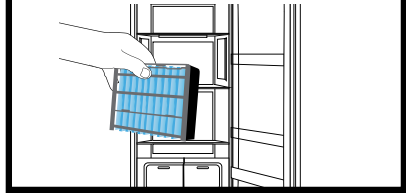

For **MAXIMUM COOLING**, place a wet cartridge in the freezer until frozen.

FILL WITH PITCHER:

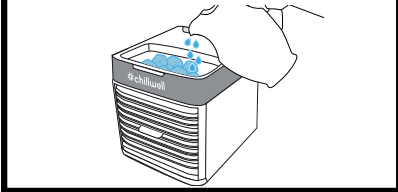

Place on a flat surface & fill tank from a water pitcher.

SET AIR FLOW:

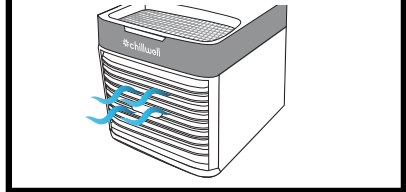

Point towards you and adjust the vents to direct the air flow.

NEW FEATURES



TURBO MODE:

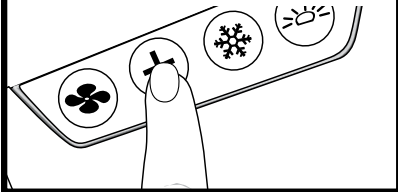

Press **+** to start **TURBO MODE** for maximum fan power and cooling.

COOLING CONTROL:

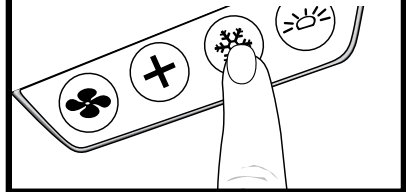

Control high or low cooling output by pressing **❄️** button.

Please Note: You may notice some condensation forming on the front grill. This is normal.

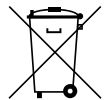

FOR HOUSEHOLD USE ONLY

Distributed by
 chillwell™

©2021 Chillwell
Las Vegas, NV
All Rights Reserved.

Made In China
U.S. Pat. No. 10,712,029
CWAC-IM-01-1221

Model Number: **18009**
AC100~120V
DC 5V, 1.5-2.0A
1217.0101